



PROFAX

ARC GOUGING TORCH AEC3000/AEC3000-1

Standard features

- Unique valve design
- Special high impact, heat resistant material
- Special hard copper alloy body w/ excellent electrical conductivity
- Easy field repair
- Available with 7' swivel or non swivel cable assembly
- Optional 12' swivel cable assembly available
- Made in the USA

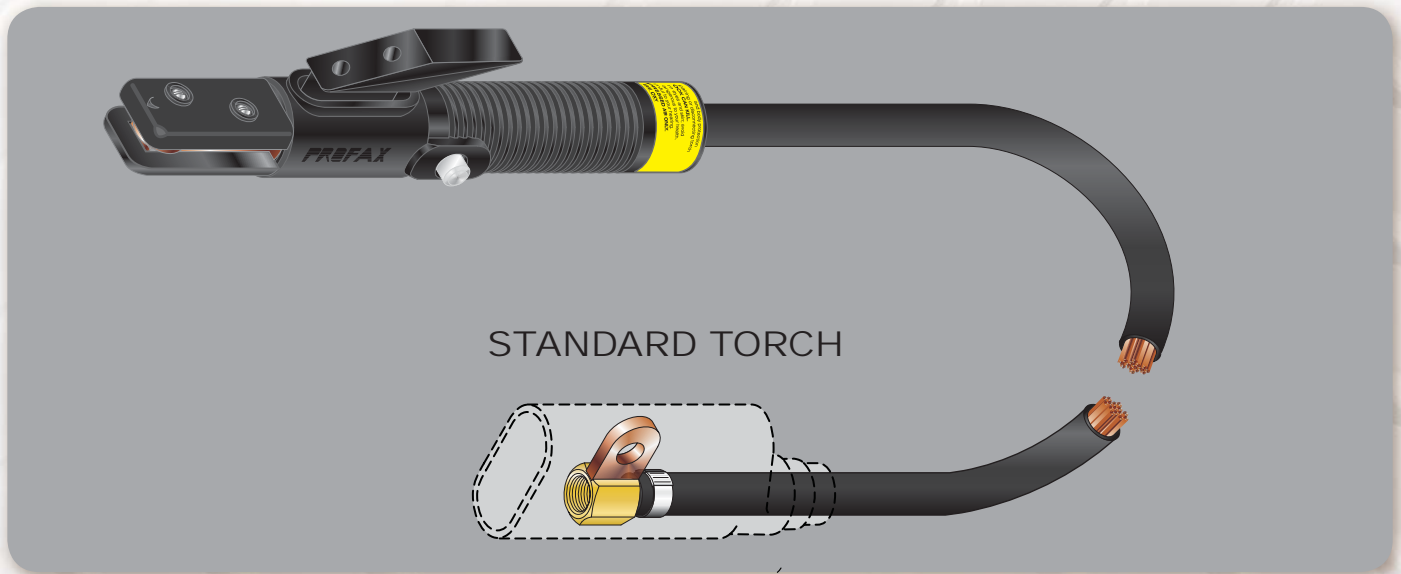

TORCH WITH AEC3-045CF INSULATION KIT INSTALLED

Part No.	Description	DC AMPS				
		5/32"	3/16"	1/4"	5/16"	3/8"
AEC3000	Complete gouging torch w/ 7ft cable assembly	90 to 150	200 to 250	300 to 400	350 to 450	450 to 600
AEC3000-045CF	Complete gouging torch w/ 7ft cable assembly w/ insulation kit installed					
AEC3000-1	Complete gouging torch w/ 7ft swivel cable assembly					
AEC3000-1-045CF	Complete gouging torch w/ 7ft swivel cable assembly w/ insulation kit installed					
AEC3000-12-1	Complete gouging torch w/ 12ft swivel cable assembly					
AEC3000-12-1-045CF	Complete gouging torch w/ 12ft swivel cable assembly w/ insulation kit installed					
AEC30001	Complete gouging torch less cable assembly					



INDEPENDENT WHOLESALE WELDING SUPPLY

Ph: 02 8834 2400 Fax: 02 8834 2498 Email: iwws@iwws.net Website: www.iwws.net



AEC3000/AEC3000-1

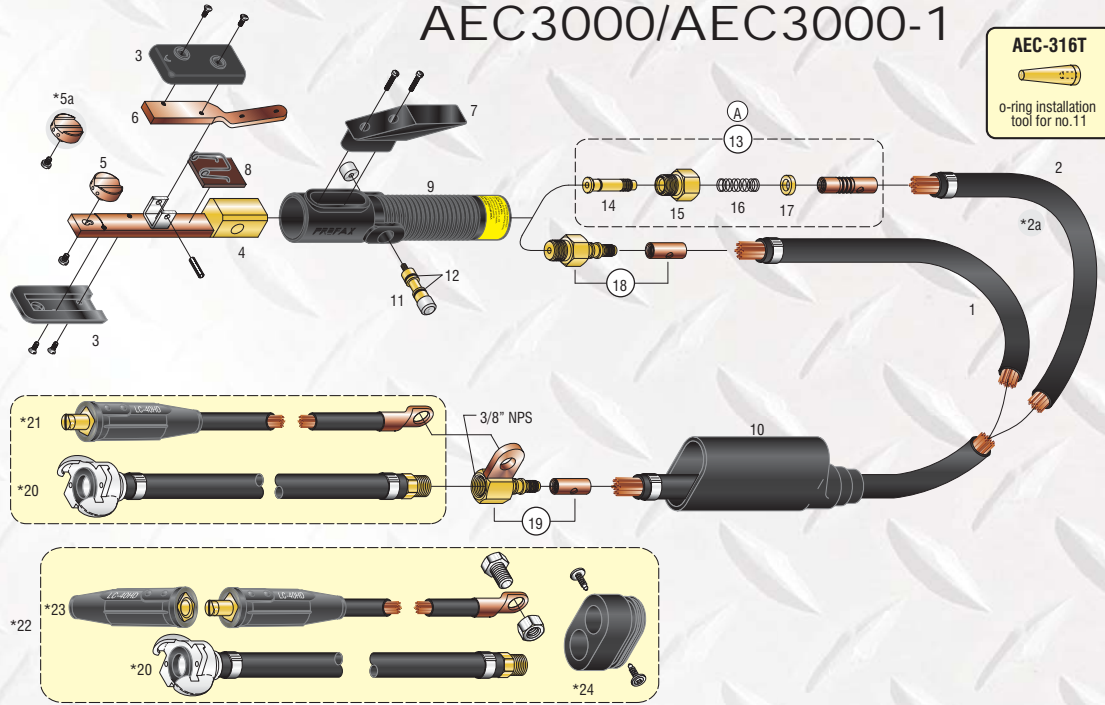

Air pressure psi (kPa)	Air consumption cfm (L/min.)	Continuous use hp (kW)
80 (550)	25 (708)	7.5 (5.6)

ITEM	DESCRIPTION	AEC3000	AEC3000-1
1	Cable assembly 7' (2.1 m)	AEC302	-
2	Swivel cable assembly 7'(2.1 m)	-	AEC302-1
*2a	Swivel cable assembly 12' (3.6 m)	-	AEC312-1
3	Insulator assembly with screws	AEC303	AEC303
4	Lower tong and valve body	AEC304	AEC304
5	Swivel head with screw	AEC305	AEC305
*5a	Flat swivel head with screw	AEC305F	AEC305F
6	Upper arm	AEC307	AEC307
7	Lever assembly with screws	AEC308	AEC308
8	Spring, insu;ator assembly	AEC309	AEC309
9	Handle	AEC350	AEC350
10	Cable insulating boot	AEC311	AEC311
11	Spool assembly	AEC316R	AEC316R
12	O'ring (2 pk)	AEC316-1R	AEC316-1R
13	Swivel joint assembly	-	AEC321
14	Swivel joint stem	-	AEC322
15	Swivel joint male nut	-	AEC323
16	Swivel joint spring	-	AEC326
17	Swivel joint bushing	-	AEC327
18	Male cable connector assembly	AEC3-028	-
19	Female cable connector assembly	AEC3-029	AEC3-029
*20	Air hose extension 18" (45 cm) long with crow foot connection	AEC3-040	AEC3-040
*21	Power cable extension 3/0 cable 18" (45 cm) long with LC-40HD male	AEC3-041TW	AEC3-041TW
*22	Power/Air insulation kit	AEC3-045CF	AEC3-045CF
*23	Power cable extension 3/0 18" (45 cm) long cable with LC-40HD male & LC-40HD female	AEC3-042	AEC3-042
*24	Insulating block	AEC312	AEC312

* Items are optional

