

SUMNER

BEAM - JAX



- Steel casters standard
- 2,500 lb (1,135 kg) Load capacity
- Safely handles beams up to 24" (61 cm) in width

Part Number	Description	Kg
781485	Basic Beam Jax	23.1
781486	Beam Jax Kit (Beam Jax & Casters)	54.8

Specifications		
Basic Unit	Height	27.8" (705 mm)
	Width	29.6" (752 mm)
Basic Unit with Casters	Height	37.3" (947 mm)
	Width	39.5" (1,003 mm)
Beam Head Height	Min.	25.5" (648 mm)
	Max.	37.5" (953 mm)
Beam Head Height with Casters	Min.	35.0" (889 mm)
	Max.	47.0" (1,194 mm)



INDEPENDENT WHOLESALE WELDING SUPPLY

Ph: 02 8834 2400 Fax: 02 8834 2498 Email: iwws@iwws.net Website: www.iwws.net

SUMNER

BEAM - JAX PARTS

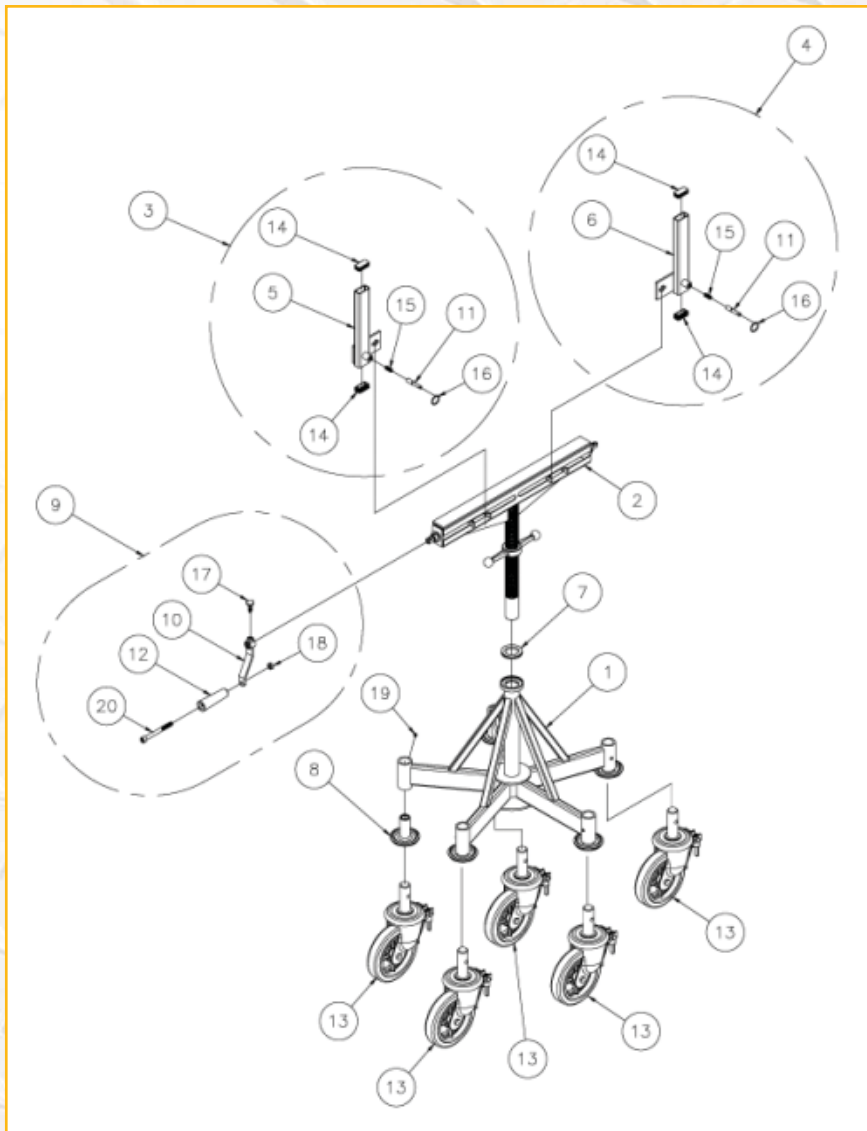

	Part No	Description
1	781459	Base Weldment, Max-Jax (5 Leg)
2	781490	Beam Jax Head Assembly
3	781500	Clamp, Left Beam Jax
4	781501	Clamp, Right Beam Jax
5	781504	Clamp Arm Weldment, Left
6	781505	Clamp Arm Weldment, Right
7	781425	Thrust Washer
8	781396	Max Jax Leveling Pad
9	784185	Winch Handle Assy, Beam Jax
10	784186	Winch Handle Weldment, Beam Jax

	Part No	Description
11	782510	Plunger
12	780182	Winch Handle Sleeve
13	779023	Caster, Roller Wheel
14	779930	Cap, 1 x 2 Rect Tube, Black
15	776212	Spring, #C0480-042-1250-M
16	775110	Split-Ring 1-1/4" (31.7 mm) NICK.PLTD.
17	774180	Spring Plunger, 1/4" (6.35 mm) Dia
18	772358	Nut, Hex Jam Lock 1/2-13" (12.7 - 330.2 mm)
19	771460	Screw, SHSS 3/8-16 X 3/8 (9.52 - 406.4 mm x 9.52 mm) Cup PT
20	771254	SHCS 1/2-13 X 5 (12.7 - 330.2 mm x 127 mm)



INDEPENDENT WHOLESALE WELDING SUPPLY

Ph: 02 8834 2400 Fax: 02 8834 2498 Email: iwws@iwws.net Website: www.iwws.net