

# SUMNER

## PRO ROLL

Fits 1/2" to 36"  
(1.2 to 91 cm) pipe

Interchangeable heads to match  
the job (see below options)

Handle large enough to  
work with gloved hand

Roller adjustment from either side

Galvanized inside tube  
resists corrosion

Quick action lock washer for fast  
height positioning

Patented Fall Guard  
feature allows 1" (2.5 cm) safety  
zone around lock washer

Brake to lock loads for layout or fit-up

Wheels trued for true pipe rotation

Quick change design increases  
roller stand utility

Levelling on either side of stand

Set screw for double margin of safety

Formed steel legs

23"  
(58.5 cm)

31"  
(80 cm)



783151- Carbon Steel Roller Head  
783153 - Stainless Steel Roller Head



783152- Rubber Wheel  
Roller Head



783154 - Ball Transfer  
Roller Head



783155 - Bar Stock Head

- 1/2 to 36" (1.2 to 91 cm) or 2,000 lb (900 kg) pipe capacity
- Clean and simple design avoids welder interference
- Bronze bearing to eliminate arcing

Part No	Description	Kg
780440	Pro Roll Base Only	17.2
780441	Pro Roll w/Roller Wheels	21.3
780442	Pro Roll w/Ball Transfer Heads	22.2
780443	Pro Roll w/Rubber Wheels	20.4
780444	Pro Roll w/Stainless Steel Wheels	21.3
780446	Pro Roll w/Bar Stock Head	22.2



INDEPENDENT WHOLESALE WELDING SUPPLY

Ph: 02 8834 2400 Fax: 02 8834 2498 Email: iwws@iwws.net Website: www.iwws.net

# SUMNER

## PRO ROLL PARTS

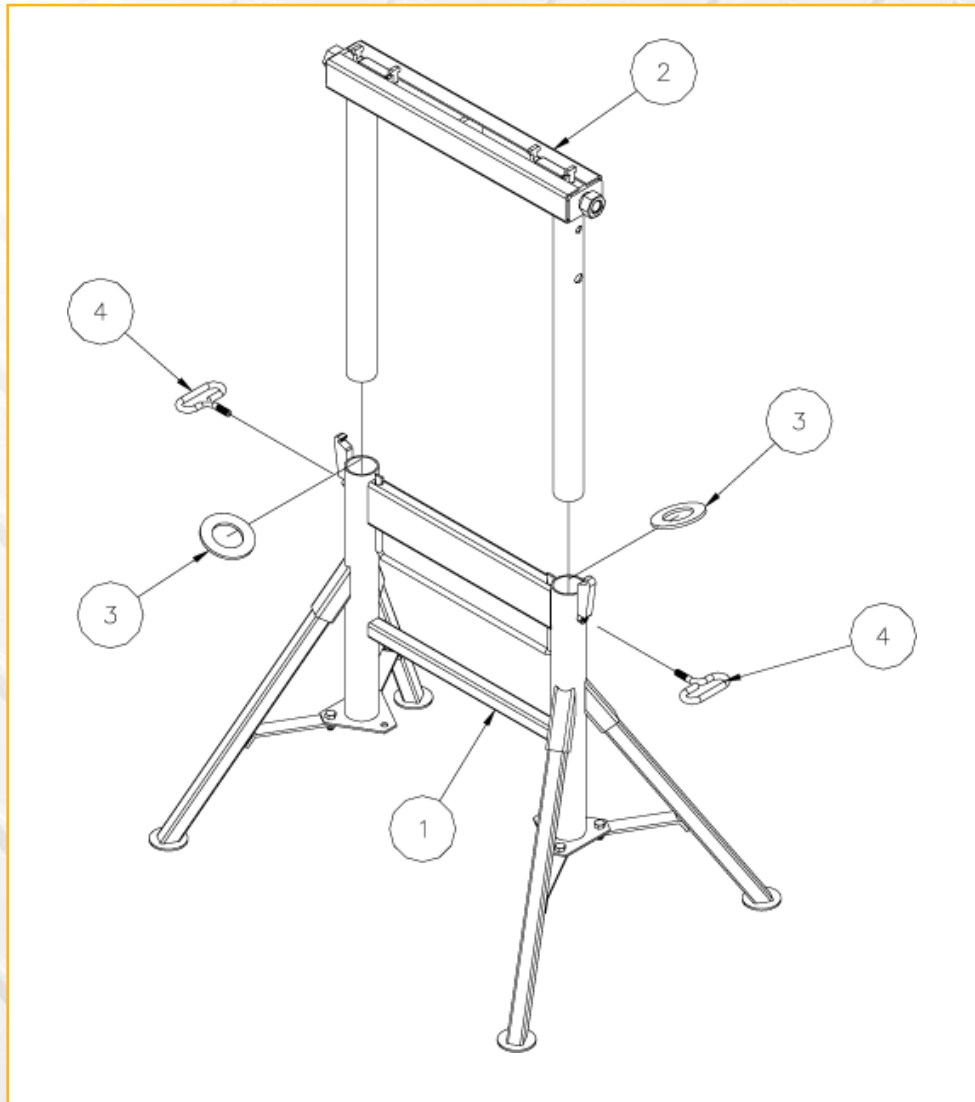

	Part No	Description
1	780439	Pro Roll Base Weldment
2	783111	Barrel Weldment, Far & Pro
3	780510	Lock Washer J-20A
4	780552	Set Screw C-110W
5	783159	Stainless Steel Ball Transfer Head (2)
	783155	Quick Change Barstock Head
	783153	Q.C.Roll HSG with Stainless Steel Wheel (1 PR)
	783152	Q.C.Roll HSG with Rubber Wheel (1 PR)
	783151	Q.C.Roll HSG with Roller Wheel (1 PR)
	783154	Q.C.Ball - Transfer Head (1 PR)



INDEPENDENT WHOLESALE WELDING SUPPLY

Ph: 02 8834 2400 Fax: 02 8834 2498 Email: iwws@iwws.net Website: www.iwws.net